

A downstream injector for low-pressure chemical applications. Features an adjustable metering knob. Use in conjunction with a double lance, adjustable nozzle, or other means of changing to low pressure while retaining system's output flow.

**Available with optional Brass adjusting knob.**



### SPECIFICATIONS

Part Number:	Volume
ZROBO 0	2.1 – 2.9 GPM
ZROBO 1	2.9 – 4.0 GPM
ZROBO 2	4.0 – 5.6 GPM
ZROBO 3	6.6 – 10.8 GPM
ZROBO 0 B	2.1 – 2.9 GPM
ZROBO 1 B	2.9 – 4.0 GPM
ZROBO 2 B	4.0 – 5.6 GPM
ZROBO 3 B	6.6 – 10.8 GPM

*"B" denotes brass knob (optional)*

Maximum Pressure	3200 PSI
Maximum Temperature	210°F
Port Sizes: Inlet/Outlet	3/8"-19 BSPP-M
Dimensions	1.0" x 2.7" x 3.1"
Weight	.6 lb.
Materials	Brass, Stainless Steel, Viton, Buna-N, Plastic

### PARTS LIST

Item	Part Num.	Description	Kit	Qty.
*	190000	REPAIR KIT	*	
1.	10007870	Nipple, Ø.118" (3.00 mm) – ROBOKIM 0,1,2		1
	10016070	Nipple, Ø.128" (3.25 mm) – ROBOKIM 3		1
2.	90383200	O-Ring	*	1
3.	10015166	Nozzle, Ø.079" (2.00 mm) – ROBOKIM 0		1
	10007666	Nozzle, Ø.087" (2.20 mm) – ROBOKIM 1		1
	10007766	Nozzle, Ø.098" (2.50 mm) – ROBOKIM 2		1
	10016266	Nozzle, Ø.108" (2.75 mm) – ROBOKIM 3		1
4.	701614	O-Ring	*	1
5.	10038941	Body		1
6.	94821700	Spring	*	1
7.	97478200	Ball	*	1
8.	701501	O-Ring	*	1
9.	10038870	Hose Barb/Seat		1
10.	701016	O-Ring	*	1
11.	701612	O-Ring	*	1
12.	10038751	Adjustment Knob, Plastic		1
	510010	Adjustment Knob, Brass (optional)		

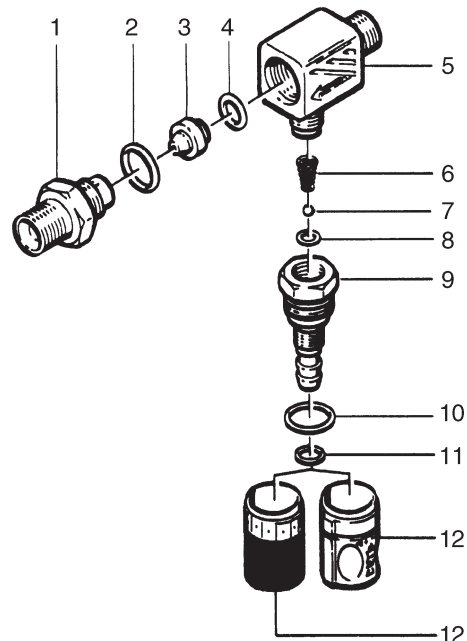

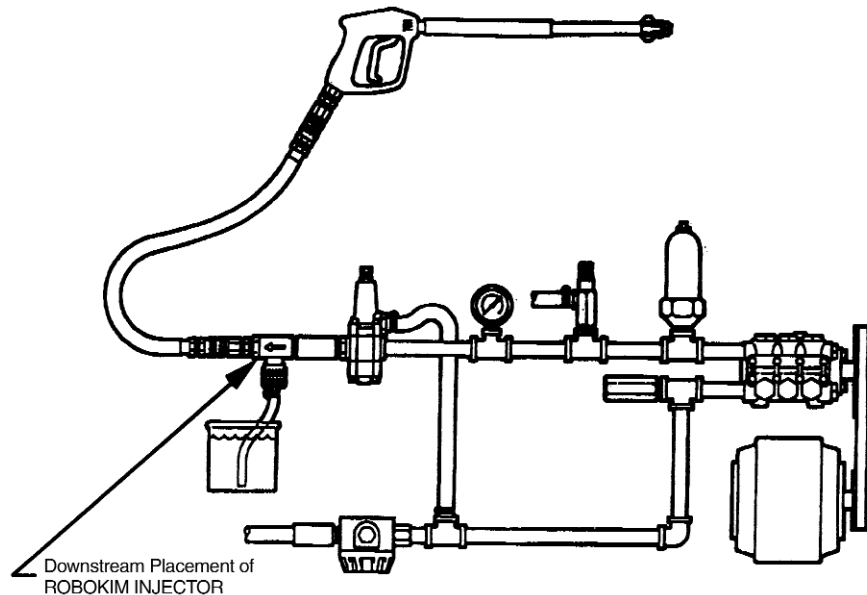

### INSTALLATION/SET-UP

Be sure that this accessory as well as all other components exceeds the system's maximum pressure rating. The system's output flow must be within the volume specification of this chemical injector for proper system operation and acceptable back pressure.

Refer to the arrow on the injector valve body for proper flow direction. Install the injector in the system downstream of the regulator/unloader which is downstream of the pump. Use the 3/8" male inlet/outlet threads for mounting. Attach a piece of 5/16" ID tubing to the chemical inlet hose barb. Be sure that the tubing you select is compatible with the chemicals you will be using. Be sure to install an appropriate filter on the tubing.

A spray tip or nozzle must be selected to produce 125 PSI or less at system's output volume. A double lance, twin nozzle holder, or adjustable nozzle may be used for easy switching from high to low pressure.

These injectors will draw your chemical into the water stream at 125 PSI and 2.1 to 10.8 GPM (through your low pressure spray tip) and will not draw chemical above 250 PSI (through your high pressure spray tip). The amount of chemical being drawn in is controlled with the adjustment knob (item 12).