

IOTA-17

Low Pressure Diaphragm Pump

IOTA-17 low pressure diaphragm pumps are excellent for various horticultural, agricultural, lawn care, nursery and turf spraying applications. They are also effectively utilized in other applications such as hydrostatic testing, concrete seal-coating and cleaning. Simplicity of design and common parts allow easy and affordable maintenance. Built-in pulsation dampener, control valve and pressure gauge are standard.

The IOTA-17 is constructed of anodized aluminum with stainless steel and anodized aluminum liquid handling parts.

Several drive options are available, including:

Part Number	Description
5028.76	3 HP Gear Reduction
7750.31	3/4" Solid Keyed Shaft and Bolts
7751.A3	1" Solid Keyed Shaft and Bolts
7752.A2/BK-17	1-3/8" 6-Spline Female Adapter & Bolts, Torque Arm, Chains and Safety Shield.

For industrial uses and spraying applications not listed, please consult UDOR U.S.A.

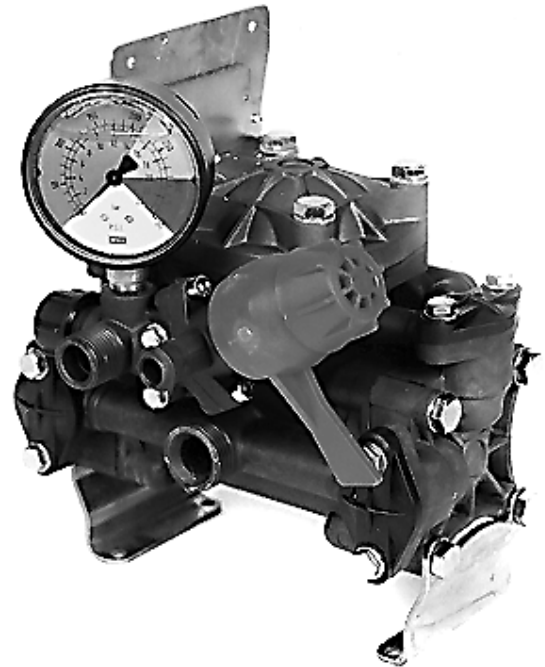

SPECIFICATIONS

Maximum Flow	4.8 GPM
Maximum Pressure	275 PSI
Maximum Temperature	140°F
Hose Barb Ports	
In	3/4"
Out	3/8"
Bypass	5/8"
Dimensions	L-8.2" x W-7.5" x H-8.2"
Weight	14 lbs.
Diaphragm Material	
Standard	DESMOPAN
Optional	BUNA-N

NOTE - Protect pumps from freezing. If freezing conditions exist, flush pump and system with a 50/50 mixture of antifreeze and water.

UDOR U.S.A., INC.

500 Apollo Drive
Lino Lakes, MN 55014
TEL. (651) 785-0666
FAX. (800) 732-2670
www.udorusa.com

IOTA-17 - Exploded View Diagram and Parts List

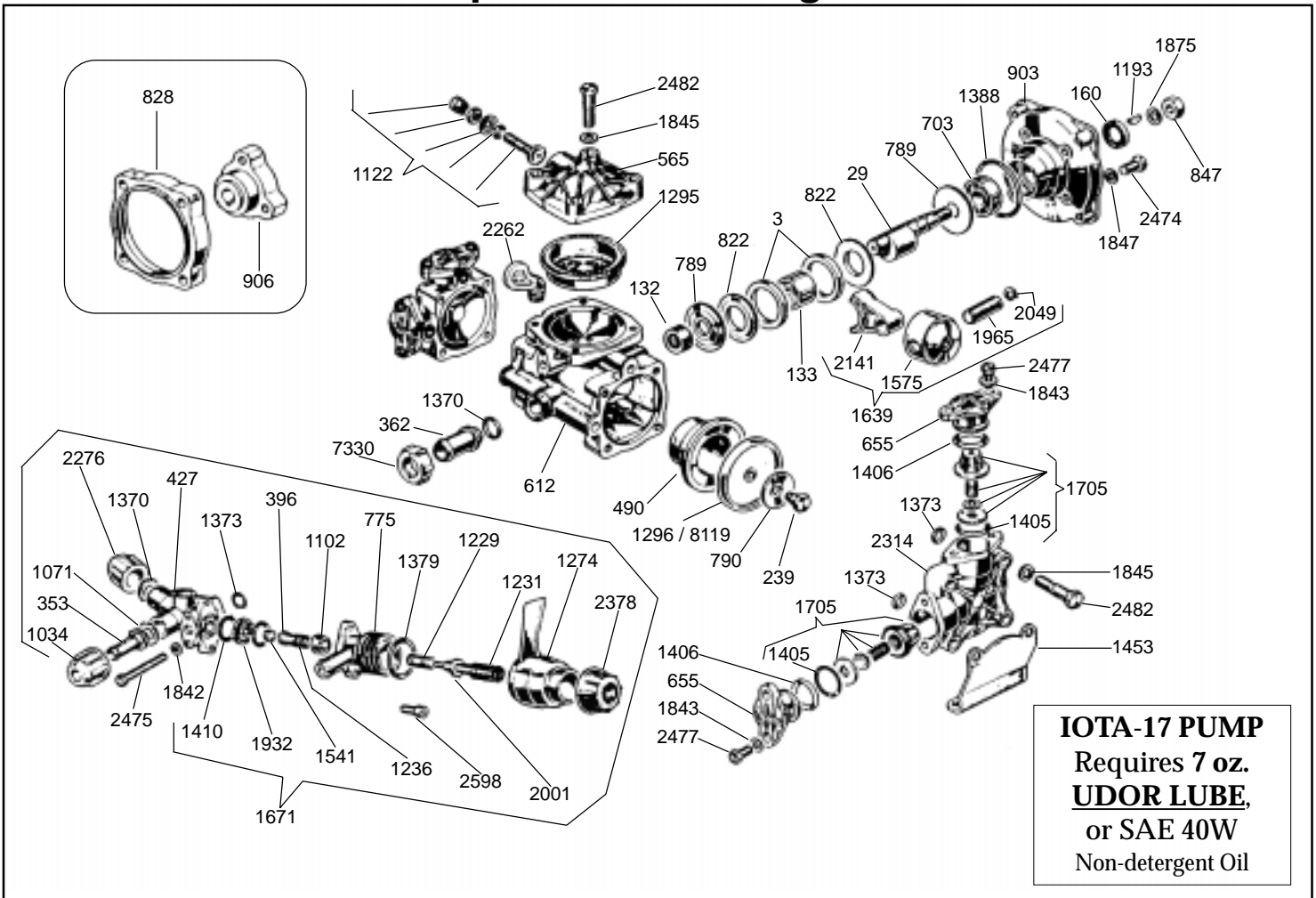

REF#	PART#	DESCRIPTION	QTY	REF#	PART#	DESCRIPTION	QTY
3	0001.04	Retainer Ring	2	*1373	1101.11	O-Ring	5
29	0002.10	Crankshaft	1	1378	1101.16	O-Ring	1
132	0006.01	Bearing	1	**1379	1101.23	O-Ring	1
133	0006.02	Bearing	1	1387	1101.35	O-Ring	1
160	0007.11	Seal	1	1388	1101.36	O-Ring	1
239	0102.02	Diaphragm Bolt	2	1405	1101.10	O-Ring	4
353	0202.09	Discharge Hose Barb	1	1406	1101.17	O-Ring	4
362	0202.27	Suction Barb	1	**1410	1101.69	O-Ring	2
**396	0203.08	Valve Collar	1	1453	1202.17	Base	2
427	0204.41	Control Valve Body	1	**1541	1204.15	R.V. Collar	1
490	0206.16	Piston Sleeve	2	1575	1205.13	Aluminum Piston	2
565	0208.31	Accumulator Head	1	1639	6000.04	Piston & Rod Assembly	2
612	0209.19	Pump Body	1	1671	6010.23	Control Valve Assembly	1
655	0211.04	Valve Retainer	4	1705	6006.04	Valve Assembly	4
703	0214.08	Ball Bearing	1	1842	1403.04	Washer	2
775	0252.01	Regulator Valve Body	1	1843	1403.07	Washer	8
789	0301.08	Washer	2	1845	1403.10	Washer	8
790	0301.09	Retainer Washer	2	1847	1403.12	Washer	4
822	0302.11	Pump Spacer	2	1875	1404.01	Washer	1
828	0302.07	14MM Spacer	1	**1932	1501.20	Regulator Washer	1
847	0303.10	Hex Nut	1	1965	1502.04	Connecting Rod Pin	2
903	0501.47	Flange	1	**2001	1503.12	Regulator Stem	1
906	0501.05	Flange	1	2049	1506.11	Snap Ring	4
1034	0604.09	Discharge Barb Nut	1	2141	1519.07	Aluminum Connecting Rod	2
1071	0605.05	Gasket	1	2262	1603.24	Plug	1
1102	0606.01	Gasket	1	2276	1603.42	Cap	1
1122	0608.15	Air Valve Assembly	1	2314	1604.30	Head	2
1193	0801.03	Key	1	2378	1801.13	Adjustment Knob	1
1229	0901.31	IOTA Spring	1	2474	1804.57	Bolt	4
1231	0901.06	Spring	1	2475	1804.61	Bolt	2
1236	0901.37	Spring	1	2477	1804.67	Bolt	8
1274	0902.12	Regulator Handle	1	2482	1804.09	Bolt	12
*1295	0903.08	Accumulator Diaphragm	1	2598	1805.21	Bolt	2
1296	0903.09	Piston Diaphragm (BUNA-N)	2	7330	0604.29	Barb Nut	1
**1370	1101.06	O-Ring	2	*8119	0903.41	Piston Diaphragm (DESMOPAN)	2

* Parts Included in Diaphragm Repair Kit - #8700.01. (Also available in BUNA-N - #8700.08.)

** Parts Included in Relief Valve Repair Kit - #8701.01.